

Bosch Climate 5000AA Series

BMS-500-AAS-012-0CS, BMS-500-AAS-012-1CS

Single Zone - Outdoor Units

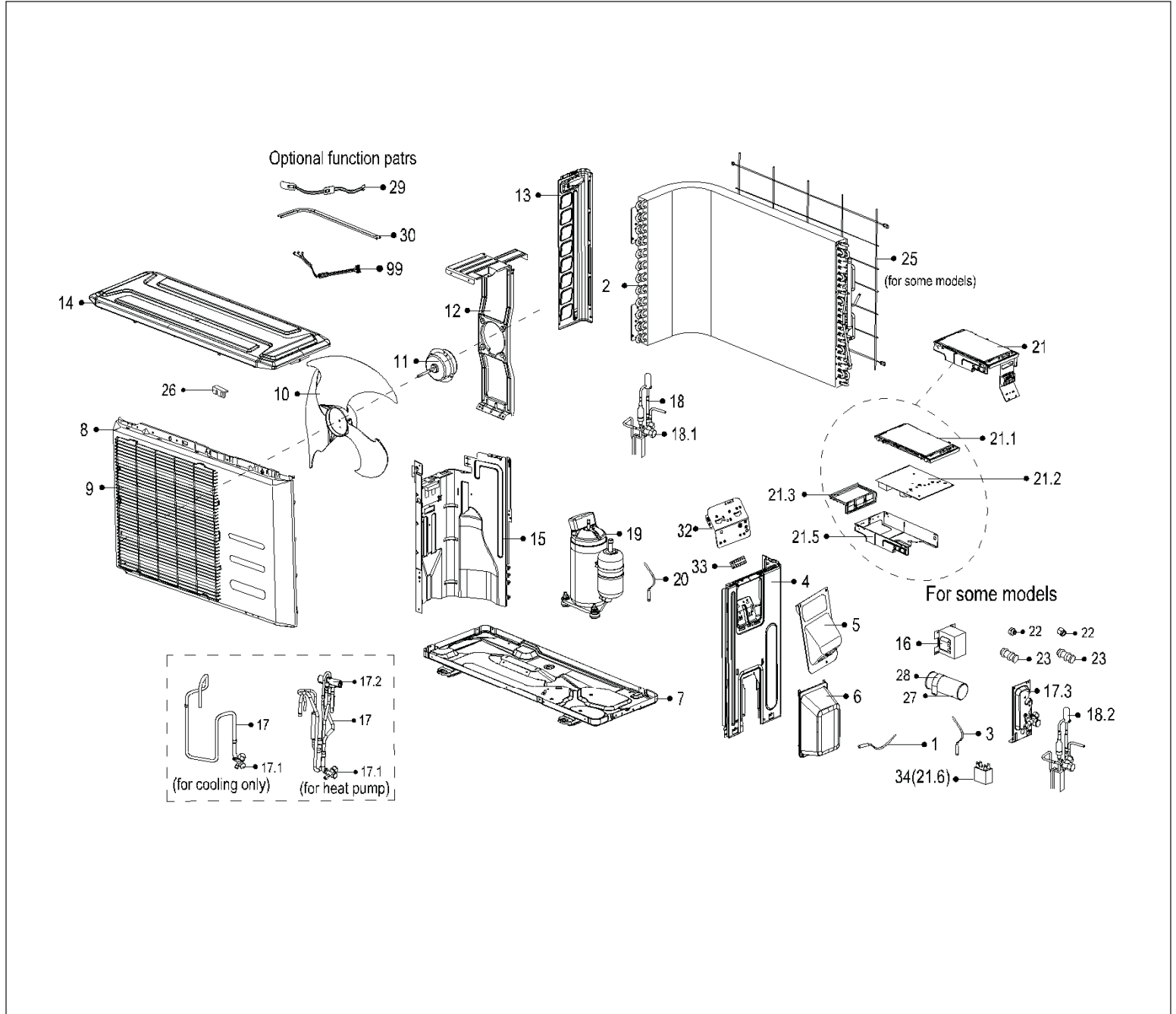

Pos.	Description	Ordering no.			Remarks
			12000 BTU (11.5V)	12000 BTU	
1	Room Temperature Sensor	7738005558	■	■	
2	Condenser assembly	7738005596	■	■	
3	Pipe temperature sensor assembly	7738005560	■	■	
4	Right clapboard assembly	7738005597	■	■	
5	Big handle	7738005562	■	■	
6	Water Collecting Cover	7738005563	■	■	
7	Chassis assembly	7738005598	■	■	
8	Front panel	7738005599	■	■	
9	Air outlet grille	7738005566	■	■	
10	Axial fan	7738005756	■		
10	Axial fan	7738005600		■	
11	Brushless DC Motor	7738005568	■	■	
12	Supporter assembly of fan motor	7738005601	■	■	
13	Left supporter	7738005602	■	■	
14	Top cover assembly	7738005603	■	■	
15	Separator Assembly	7738005604	■	■	
16	Reactor	8733947977	■		
17	4-Ways valve assembly	7738005605		■	
17	4-Ways valve assembly	7738005757	■		
17.1	Low Pressure Valve	7738005606	■	■	
17.2	4-way Valve	7738005575		■	
17.2	4-Ways valve	7738005753	■		
17.3	Installing plate for valves	7738005576	■	■	
18	High-Voltage valve Assembly	7738005577		■	
18	High-Voltage valve Assembly	7738005758	■		
18.1	Liquid valve	7738005578	■	■	
18.2	Electric expansive valve assembly	7738005579		■	
19	DC Inverter Rotary Compressor	7738005607	■	■	
20	Discharge temperature sensor assembly	7738005581	■	■	
21	Electronic control box assembly	8733947986		■	
21	Electronic control box assembly	7738005608	■		
21.1	Electric Installing Box Cover	7738005583	■	■	
21.2	Outdoor main control board assembly	8733947987		■	
21.2	Outdoor main control board assembly	7738005609	■		
21.3	Installation board for E-parts	7738005585	■	■	
21.5	Electric Installing Box Subassembly	7738005586	■	■	
25	Rear Net	7738005610	■	■	
27	Compressor Capacitor(Round)	8733947978	■		
28	Capacitor Clamp	8733947979	■		
30	Electrical Heating Tube	8733947988		■	
30	Electric heater of chassis	8733947981	■		
BMS-500-AAS-012-0CS, BMS-500-AAS-012-1CS					

