

Bosch Climate 5000AA Series BMS-500-AAS-024-1CS Single Zone - Outdoor Units

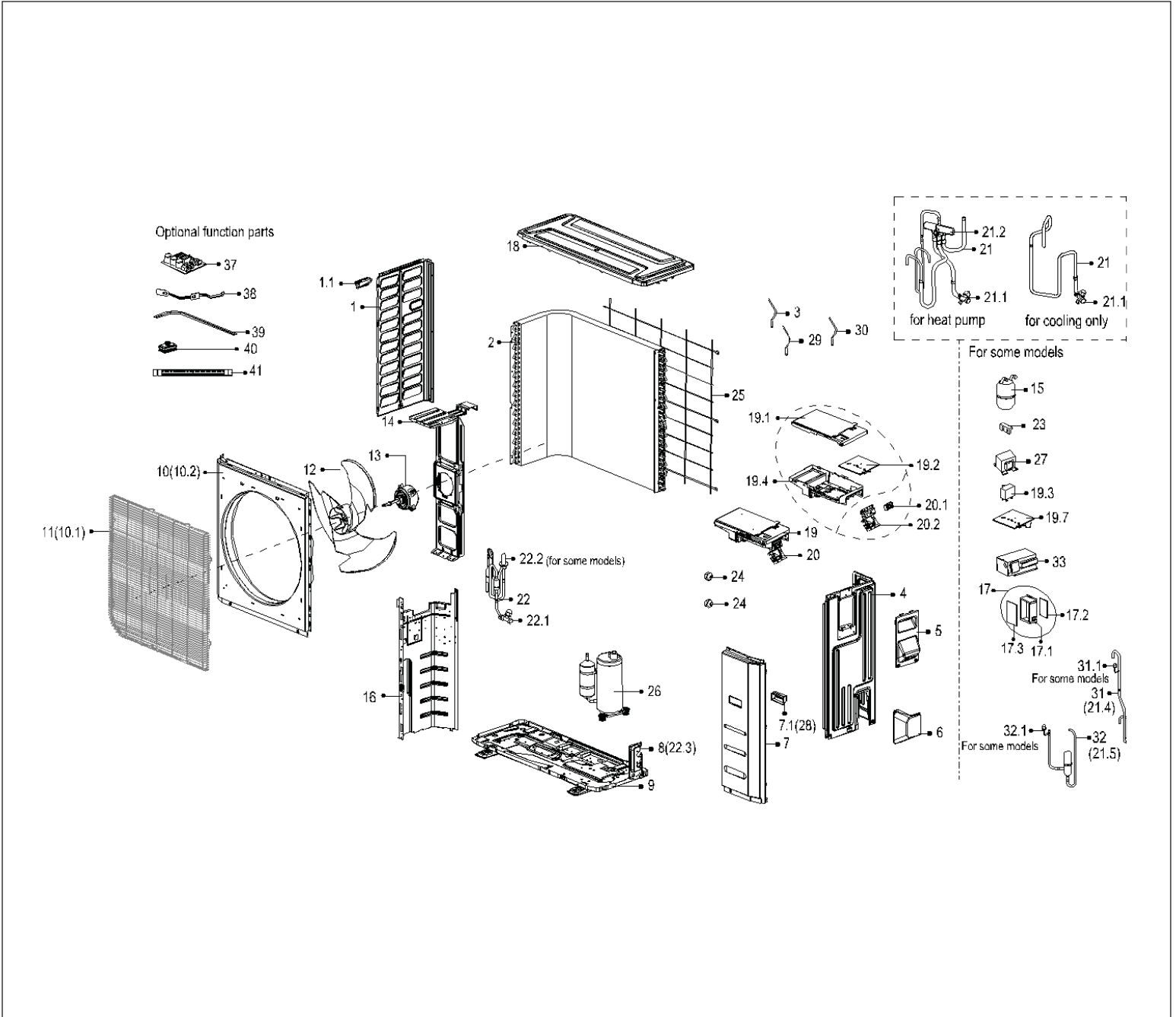

Pos.	Description	Ordering no.	BMS-500-AAS-024-1CS				Remarks
1	Left side plate assembly of cabinet	7738005666	■				
1.1	Small Handle	7738005667	■				
2	Condenser assembly	7738005668	■				
3	Temperature Sensor	7738005669	■				
4	Rear right clapboard assembly	7738005670	■				
5	Big Handle	7738005671	■				
6	Water Collecting Cover	7738005672	■				
7	Front right clapboard assembly	7738005673	■				
9	Chassis assembly	7738005675	■				
10	Front panel	7738005676	■				
11	Air outlet grille	7738005677	■				
12	Axial fan	7738005678	■				
13	Brushless DC Motor	7738005679	■				
14	Holder for fan motor assembly	7738005680	■				
16	Separator Assembly	7738005681	■				
18	Topcap assembly	7738005682	■				
19	Electronic control box assembly	7738005683	■				
19.1	Electric Installing Box Cover Subassembly	7738005684	■				
19.2	Outdoor main control board assembly	7738005685	■				
19.4	Electric Installing Box Subassembly	7738005686	■				
20	Terminal Block Subassembly of Electrical Control Box	7738005687	■				
20.1	Wire holder	7738005688	■				
20.2	Wiring terminal installing plate	7738005689	■				
21	4-ways valve assembly	7738005690	■				
21.1	Stop valve	7738005691	■				
21.2	4-ways valve	7738005692	■				
22	Liquid valve Assembly	7738005693	■				
22.1	Low Pressure Valve	7738005574	■				
22.2	Electronic expansion valve	7738005694	■				
22.3	Installation plate for valves	7738005695	■				
25	Rear net	7738005696	■				
26	Inverter Controlled Rotary Compressor	7738005697	■				
27	Reactor	7738005698	■				
29	Discharge temperature sensor assembly	7738005699	■				
30	Room Temperature Sensor	7738005558	■				
38	Crankcase electric heater	8733945648	■				
39	Electrical Heating Tube	8733947975	■				
41	Drain pipe	8733947976	■				
99	Connection cable assembly of compressor	7738005700	■				
BMS-500-AAS-024-1CS							