

Technical Service Bulletin:

# Winterizing & Freeze Prevention

Models: 520HN, 520PN, 330PN



# BOSCH

## Introduction

Please note that the instructions in the manual state that the water heater must not be installed in a location where it may be exposed to freezing temperatures. If the heater must be left in a space which is likely to experience freezing temperatures (less than 32° F), all water must be drained from the heater. Damage as a result of improper drainage will not be covered under warranty.

## Tools needed:

- ▶ Pliers
- ▶ Bucket

## Draining the heater

1. Shut off gas to heater.
2. Shut off water supply to the heater using installer supplied cold water isolation valve. If none installed, install before proceeding.
3. Open lowest hot water faucet to drain lines and relieve pressure in heater.
4. Position a bucket below water connections to water heater.
5. Remove the retaining clip (Fig. 1, Num. 1) from the threaded bushing.
6. Remove the threaded bushing (Fig. 1, Num. 2) from the water valve.
7. Contents of heater and water lines will drain.
8. Removal of piping between the water valve and heat exchanger may be necessary to ensure all water has been drained (Fig. 1, Num. 3)

### On Models 1000P, 1600P, 260PN, 425PN:

Remove retaining clips at water valve and heat exchanger connections.

### On Models 1600H, 425HN:

Remove retaining clips at water valve and base of hydrogenerator.

9. Remove piping and save for reinstallation when heater is returned to service.



## CAUTION!

If using the AQ4 powervent, all flow switch piping should be disconnected and drained.

Figure 1

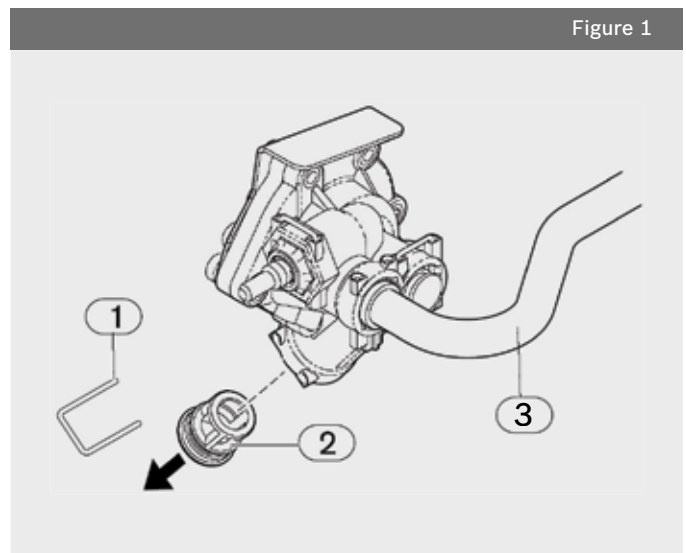

# BOSCH

Bosch Thermotechnology Corp.  
50 Wentworth Avenue  
Londonderry, NH 03053

Tel: 1-866-642-3198  
Fax: 1-603-584-1687  
www.boschpro.com