

RESETTING THERMOSTAT AND SETTING TEMPERATURE

MODELS: GL2.5, GL4.0, GL6+, GL2.5Ti,
GL4.0Ti, GL8Ti



WARNING

ELECTRICITY IS EXTREMELY DANGEROUS
SO TAKE EXTRA PRECAUTIONS WHEN
PERFORMING ANY WORK TO THE HEATER

Removing the cover

1. Remove the blue circle cover with the Ariston logo on the left of the cover plate.
2. Remove the cover screw. This holds the front panel in place.

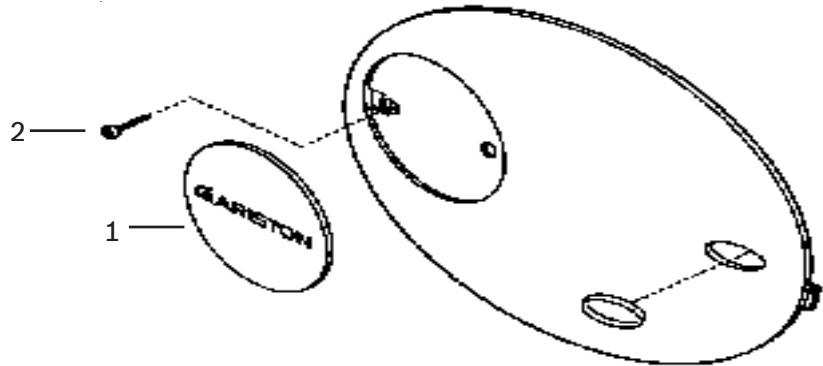

To reset thermostat or adjust Temperature setting

To adjust the temperature of the water in the GL model heaters, turn the temperature shaft to the right for hotter water and to the left for cooler water

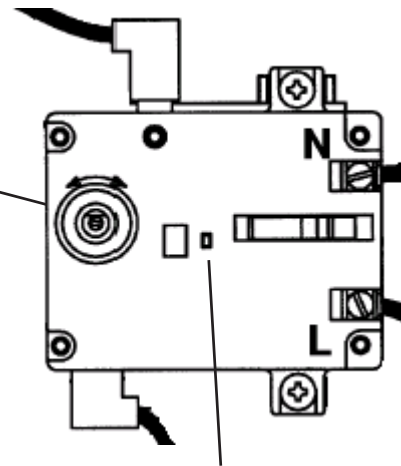

Thermostat reset button, push here to reset